

TOOL STEEL WOOD BIT EXTENSIONS

ICS USA

GENERAL PURPOSE

PRECISION GROUND



For boring jobs requiring longer reach. Extensions can be connected to one another for extra long reach. Hex wrench included.

ITEM NO.	SIZE x LENGTH	FITS SHANK SIZE	FOLLOWS DRILL SIZE OF	PRICE
WBX 016 x 06	1/4 x 6	1/4 Hex	1/2" or larger	\$4.84
WBX 016 x 12	1/4 x 12	1/4 Hex	1/2" or larger	6.24

PREMIUM TOOL STEEL CURVED HOLE WIRING BITS

ICS USA

SPECIAL PURPOSE

SPUR POINT

**1/4"
HEX SHANK**



**SELF-CENTERING
POINT**

Curved Hole Wiring Bits are designed for boring curved (right angle) holes around corners in one continuous cut. It eliminates the need to drill two holes. Ideal for routing wiring and cable for electrical installation.

ITEM NO.	SIZE	HEX SHANK	OVERALL LENGTH	PRICE
CHWB 056	7/8	1/4	6-1/4	\$14.06
CHWB 108	1-1/8	1/4	6-1/4	14.06

HOW TO USE

- 1.) Drill a straight entry hole at least 1/2" into wood.
- 2.) Then steer the bit while boring through the wood toward the desired exit hole.

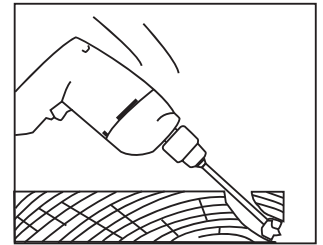

RECOMMENDED DRILLING SPEEDS

WOODS	REVOLUTIONS PER MINUTE
Soft Wood	850 - 1000 RPM
Hard Wood	600 - 850 RPM

PREMIUM TOOL STEEL AUGER SPADE BITS

ICS USA

HEAVY DUTY

MEDIUM SCREW POINT

HEX SHANK



**SELF-FEEDING
SCREW POINT**

Auger Spade Bits are designed to cut three times faster than a spade bit and do the work of an auger bit at half the cost. Ideal for overhead work, rewiring, running pipe, conduit, and more.

SIZE	HEX SHANK	OVERALL LENGTH	PRICE ASB
1/2	1/4	6	\$11.92
5/8	1/4	6	12.46
3/4	5/16	6	12.62
7/8	5/16	6	12.92
1	5/16	6	15.20

SIZE	HEX SHANK	OVERALL LENGTH	PRICE ASB
1-1/8	5/16	6	\$17.36
1-1/4	5/16	6	17.88
1-3/8	5/16	6	18.34
1-1/2	5/16	6	18.46

Quick Link

Power Bit Extensions for Auger Spade Bits are on page 173