

# CUT-OFF & GROOVING TOOL SYSTEMS

**ICS** **EUR**

**SPECIAL PURPOSE**

**PRECISION GROUND**

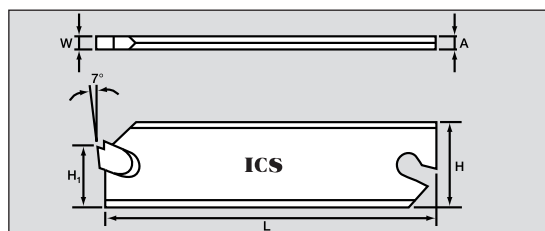

ADJUSTABLE BLADES

This new Cut-Off & Grooving Tool System is designed for use with all GTN style self-lock cut-off & grooving inserts. They are used on CNC and universal turning machines for both right and left hand turning. Adjustable blades are double ended and include an extractor. Tool block has integral clamp design for firm seating of blade. Inserts sold separately.

BLADE ITEM NO.	DIMENSIONS						FOR USE WITH			BLADE PRICE
	CUT WIDTH W	BLADE HEIGHT H	CUT HEIGHT H <sub>1</sub>	BLADE WIDTH A	BLADE LENGTH L	DIA. MAX D	TOOL BLOCK ITEM NO.	INSERT STYLE		
<b>GIH 26-3</b>	.122	1.02	.83	.091		2.95		I-GTN-3	\$50.90	
<b>GIH 26-4</b>	.161	1.02	.83	.126	4.33	3.15	GTBN-19-5	I-GTN-4	50.90	
<b>GIH 26-5</b>	.201	1.02	.82	.170		3.15		I-GTN-5	54.80	
<b>GIH 32-3</b>	.122	1.25	.97	.094			GTBN-19-6	I-GTN-3	59.20	
<b>GIH 32-4</b>	.161	1.25	.97	.126	5.91	3.94	or	I-GTN-4	59.20	
<b>GIH 32-5</b>	.201	1.25	.96	.170			GTBN-25-6	I-GTN-5	64.00	

SPARE PARTS	
EXTRACTOR	
ITEM NO.	PRICE
<b>EXT-1</b>	\$4.40

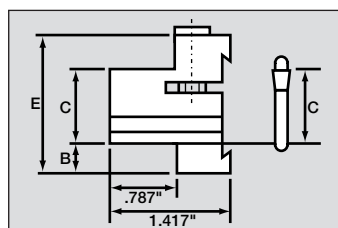
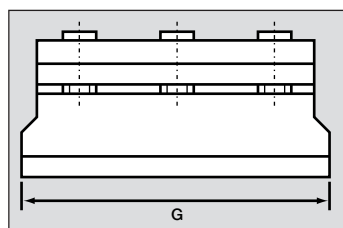

TOOL BLOCKS

TOOL BLOCK ITEM NO.	DIMENSIONS				PRICE
	B	C	E	G	
<b>GTBN-19-5</b>	.315	.787	1.50	3.5	\$94.90
<b>GTBN-19-6</b>	.512	.787	1.89	4.0	99.00
<b>GTBN-25-6</b>	.315	1.000	1.89	4.3	99.00

SPARE PARTS			
HEX KEY		CLAMP SCREW	
ITEM NO.	PRICE	ITEM NO.	PRICE
<b>HK-TB-05</b>	\$1.30	<b>CS-TB-1</b>	\$1.00